

Building demolition and Junction improvement works at A5 Cricklewood Broadway and A407 Cricklewood Lane



**Building Demolition
of
2b/2c Cricklewood Lane and
164-168 Cricklewood Broadway**

Phases 1 to 2

Phase 1

Site setup and pharmacy demolition

- Westbound road closure of Cricklewood Lane
- Pedestrians on diversion
- Bus stop suspensions
- Parking bay suspensions
- Allocation of temporary loading bays for local businesses

Starting from: 28-Sep-20
Finishing on: 24-Oct-20

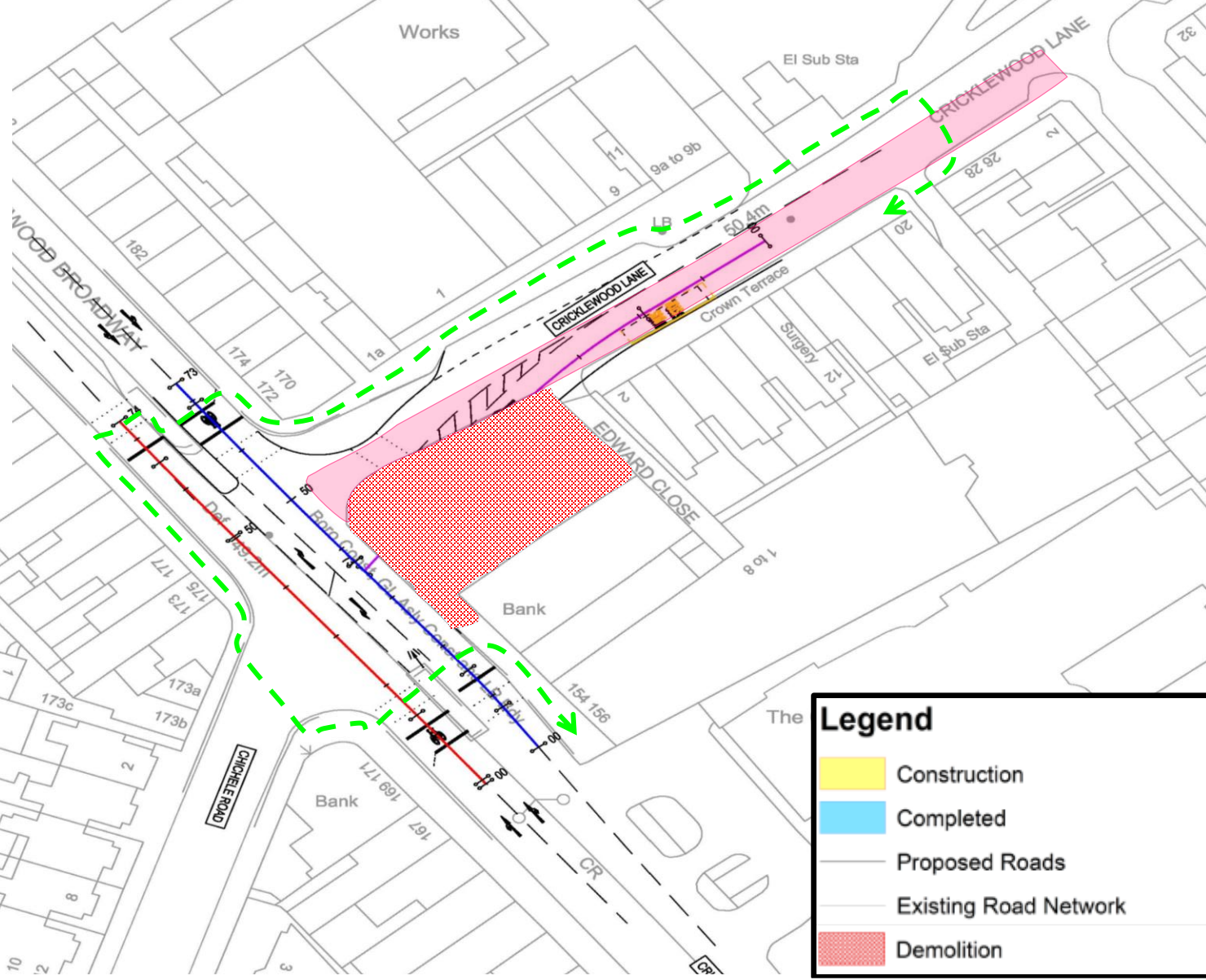

Phase 2

Demolish main building

- Junction operating with minor road narrowing on Cricklewood Lane
- Off peak southbound A5 Cricklewood Broadway Lane Closure
- Pedestrians on diversion
- Bus stop suspensions
- Parking bay suspensions
- Allocation of temporary loading bays for local businesses
- Staircase installation to Crown Terrace at end of phase

Starting from: 26-Oct-21
 Finishing on: 30-Apr-21

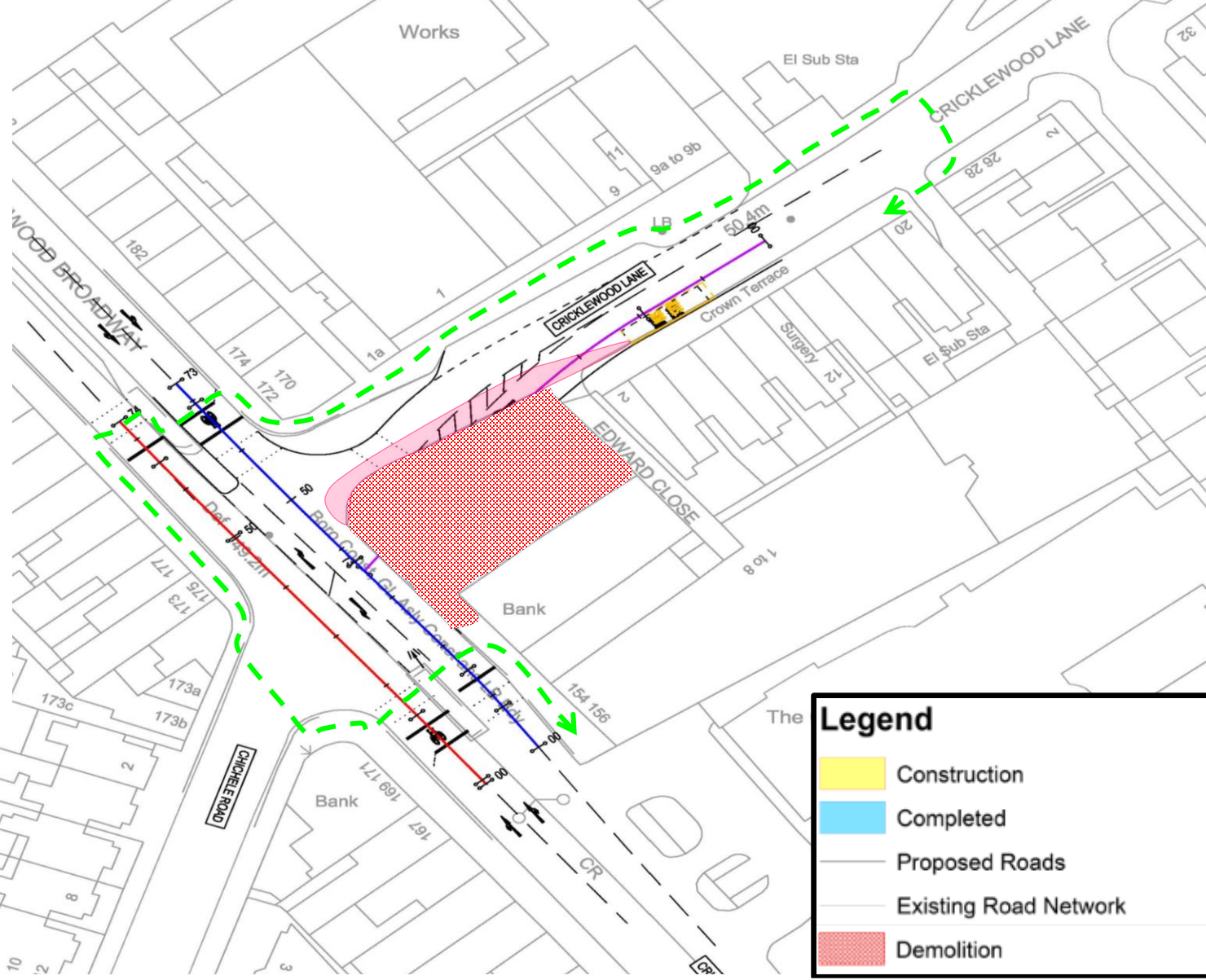

**Junction Improvement Works
at
A407 Cricklewood Lane,
A5 Cricklewood Broadway and
Chichele Road**

Phases 3 to 6

Phase 3

Junction widening

- Junction operating with minor road narrowing on Cricklewood Lane
- Off peak southbound A5 Cricklewood Broadway Lane Closure
- Pedestrians on diversion
- Bus stop suspensions
- Parking bay suspensions
- Allocation of temporary loading bays for local businesses

Starting from: 01-May-21
 Finishing on: 28-Jun-21

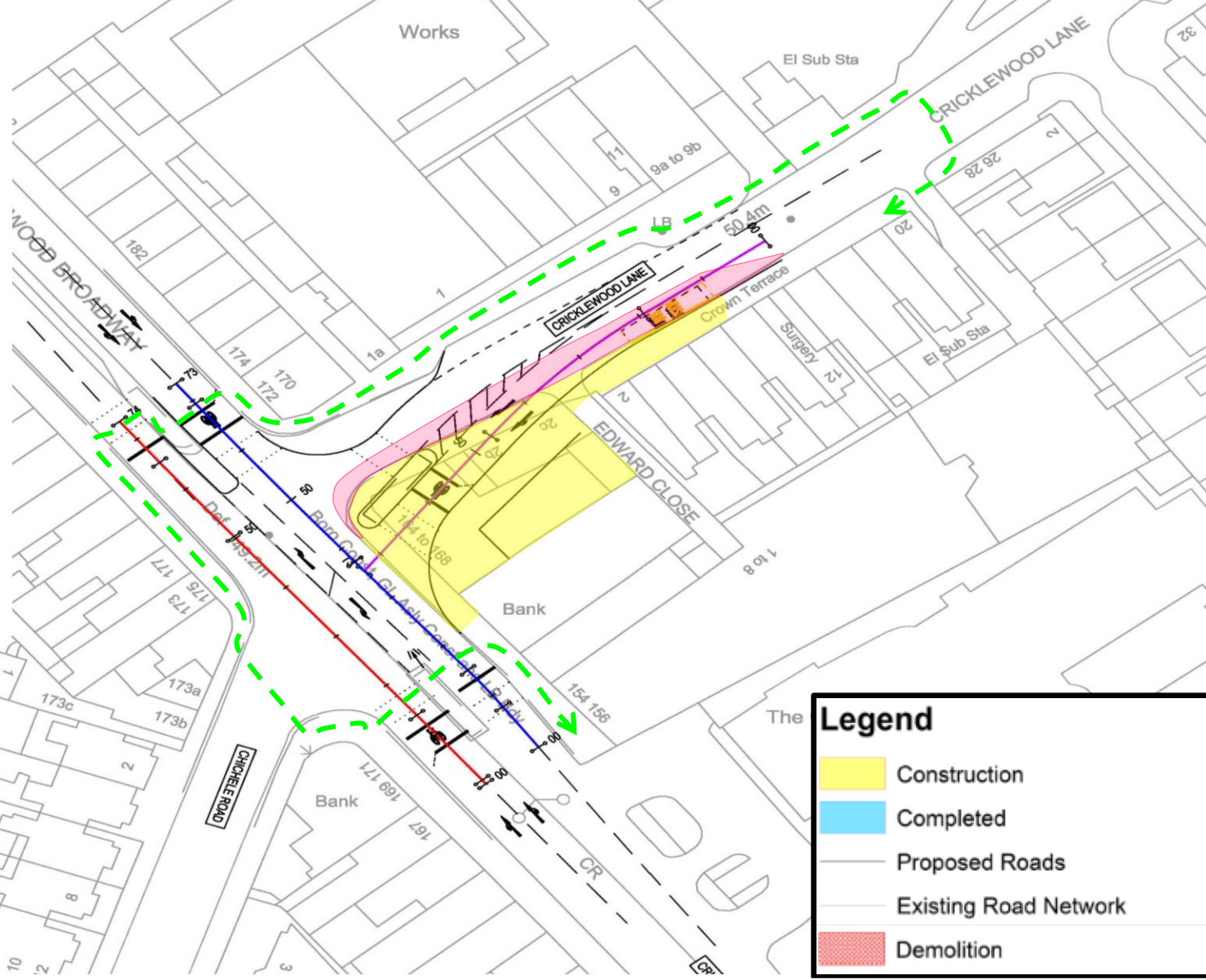

Phase 4

Junction widening

- Eastbound road closure of A407 Cricklewood Lane
- Off peak southbound A5 Cricklewood Broadway Lane Closure
- Pedestrians on diversion
- Bus stop suspensions
- Parking bay suspensions
- Allocation of temporary loading bays for local businesses

Starting from: 29-Jun-21
Finishing on: 08-Jul-21

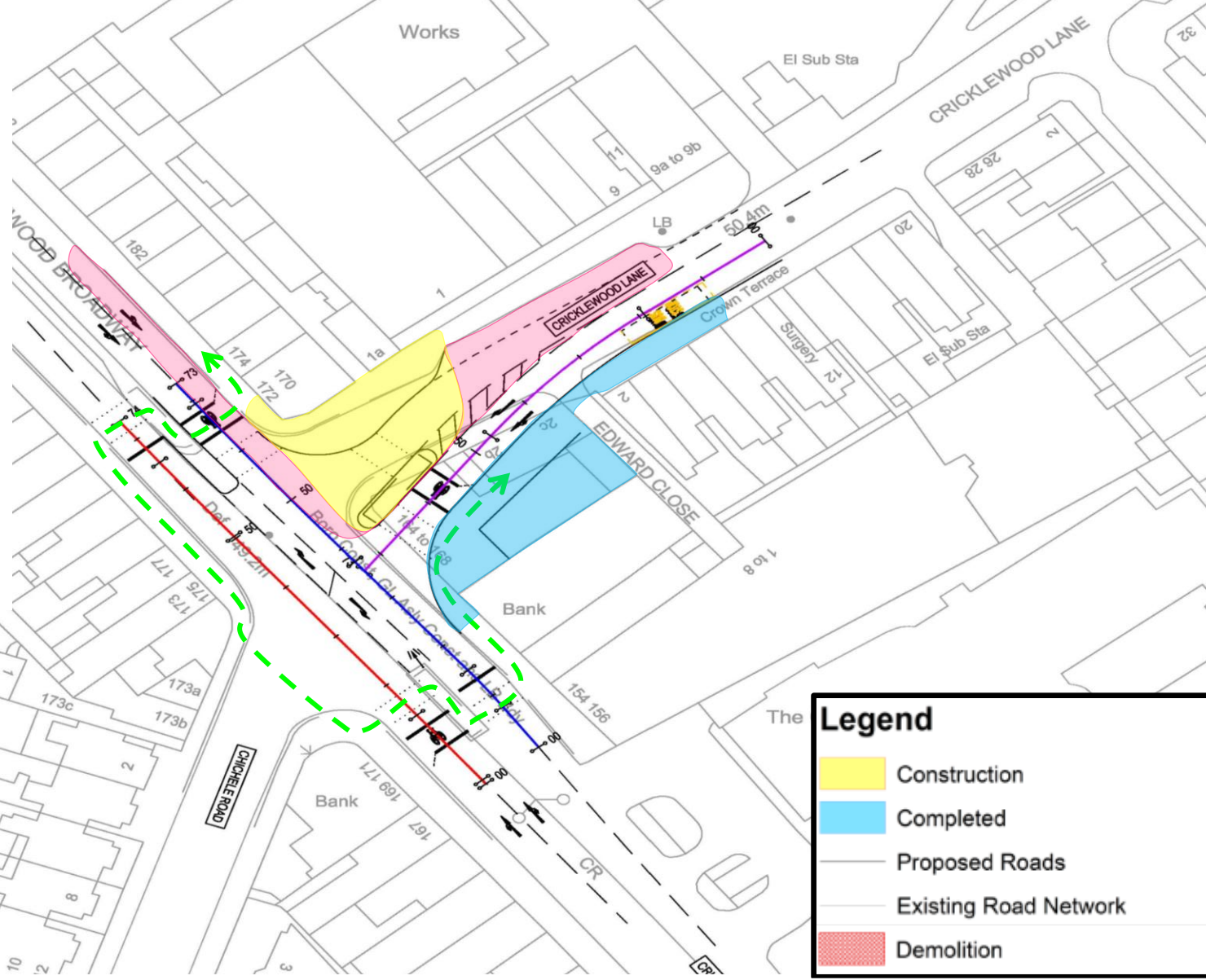

Legend

- Construction
- Completed
- Proposed Roads
- Existing Road Network
- Demolition



Phase 5

Junction widening

- **A5 Cricklewood Broadway, Lane Closure**
- **Pedestrians on diversion**
- **Bus stops suspensions**

Starting from: 09-Jul-21
Finishing on: 26-Jul-21

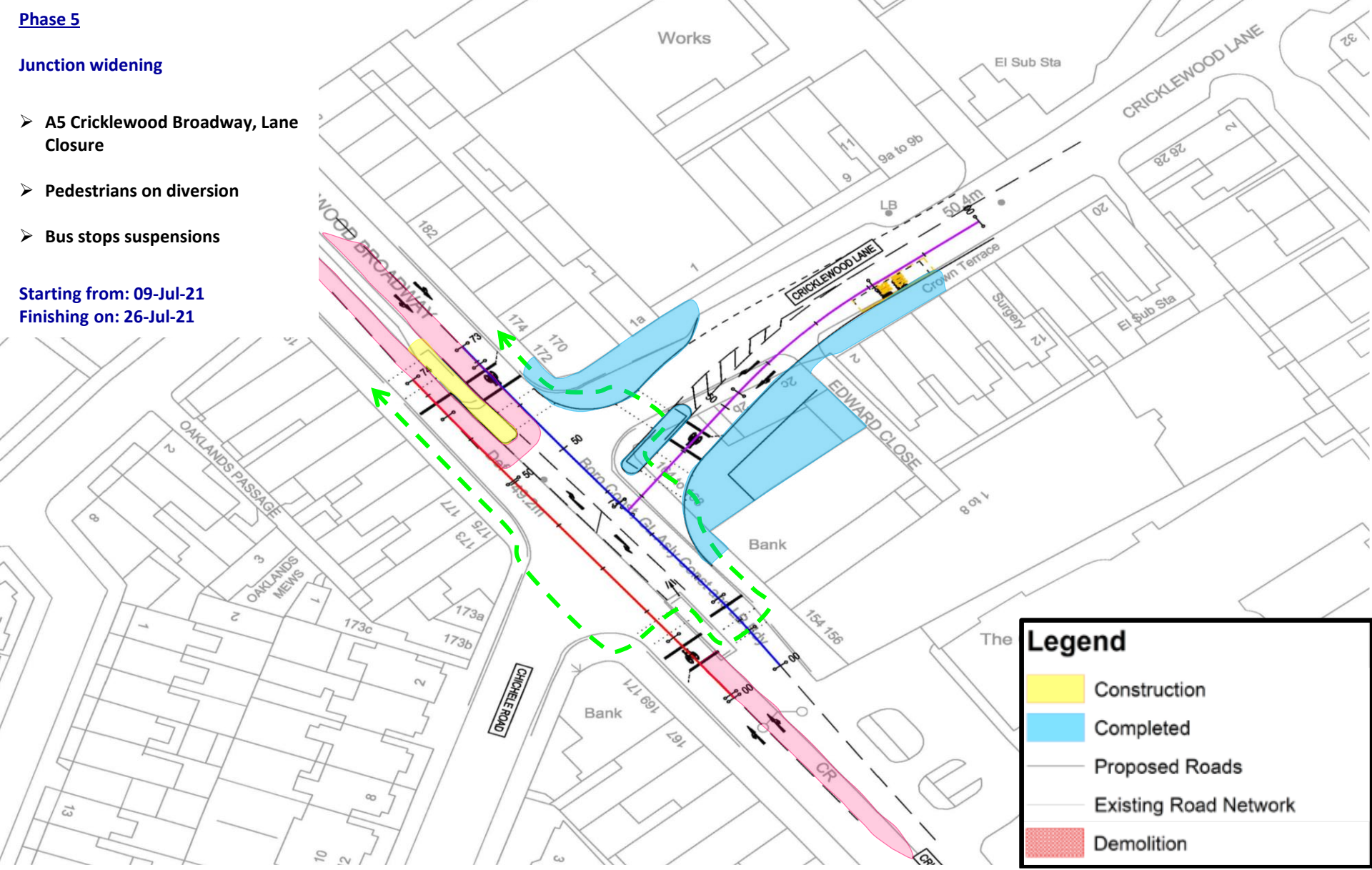

Legend

- Construction
- Completed
- Proposed Roads
- Existing Road Network
- Demolition



Phase 6

Signal modernisation works

- Off peak lane closures
Cricklewood Broadway and
Cricklewood Lane
- Junction and pedestrian
crossings to be controlled on
temporary traffic lights
- Pedestrians on diversion
- Bus stop suspensions

Starting from: 27-Jul-21
Finishing on: 18-Aug-21

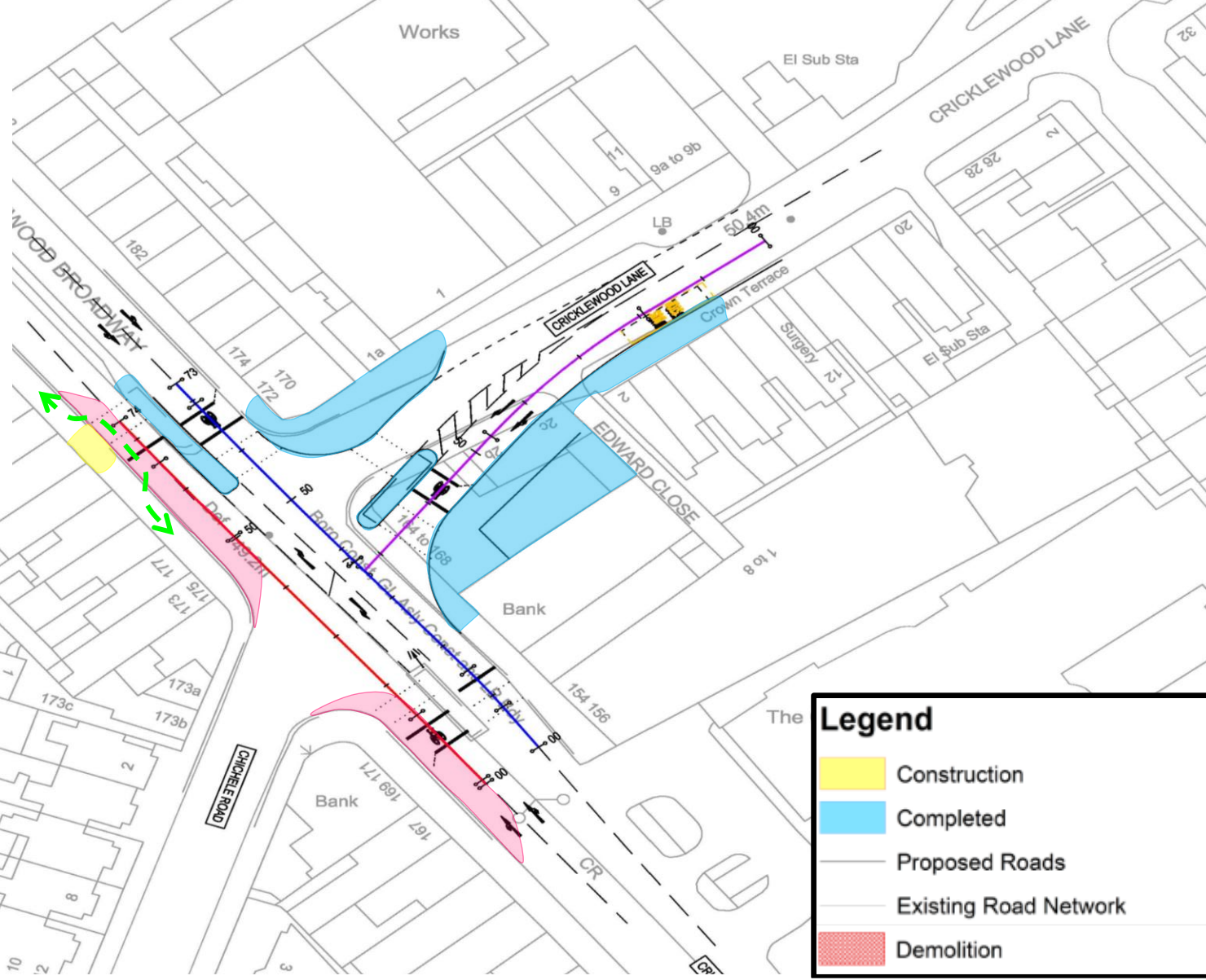

Carriageway Resurfacing Works at A407 Cricklewood Lane, A5 Cricklewood Broadway and Chichele Road

Phase 7



Phase 7

Carriageway resurfacing works

- Road closure and local diversion for Cricklewood Lane, Chichele Road, Oaklands Road and Ashford Road
- Junction to be controlled on 3 way temporary traffic lights
- Pedestrians on diversion
- Bus stops suspensions

Starting from: 19-Aug-21
Finishing on: 27-Aug-21



2020						2021											
Jul	Aug	Sep	Oct	Nov	Dec	Jan	Feb	Mar	Apr	May	Jun	Jul	Aug	Sep	Oct	Nov	Dec

Questions?